

**ChinaBalers**

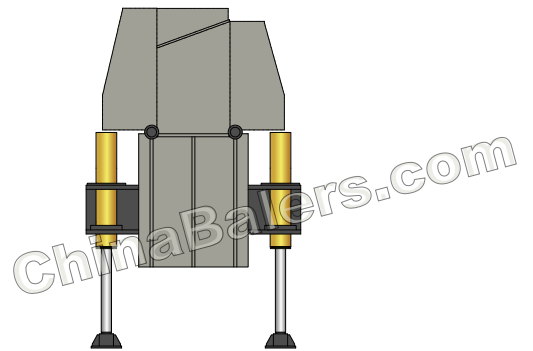

HBB Mobile Car Baler

# HBB-200

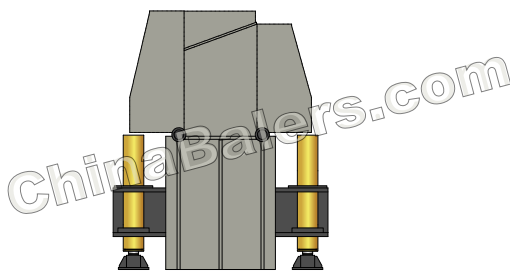
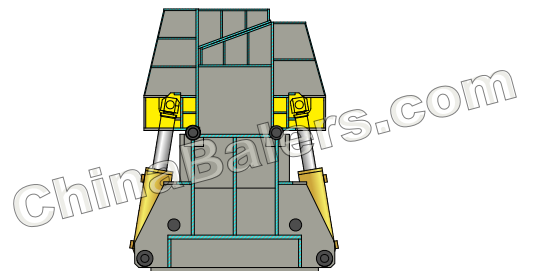
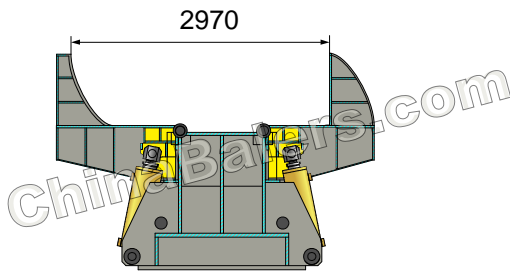
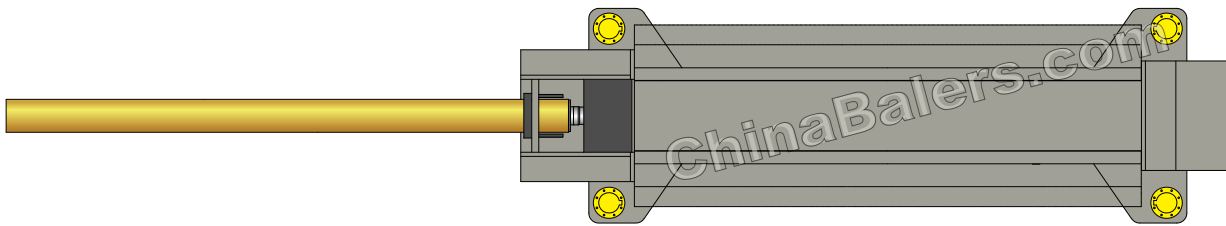
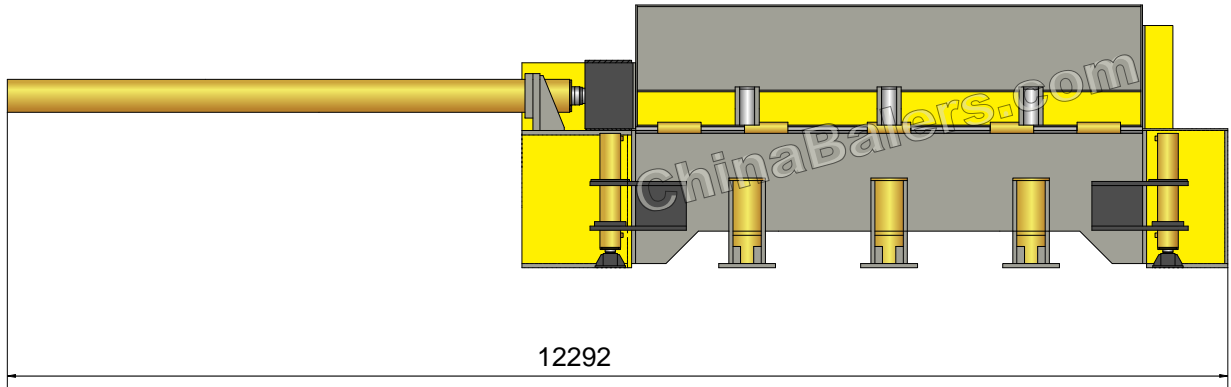
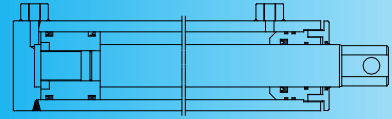

# HBB-200

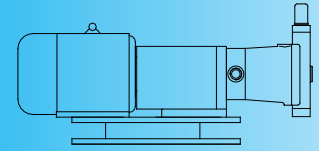

## Hydraulic Baler / Logger

Model: HBB-200

### Power System (Electrical Motor, 1 set)

Type:	Y280S-4
Rated Speed:	1480 rpm
Output:	75 kW

### System Parameters

Wing Cyl. Force:	3×80 Ton
Lid Cyl. Force:	3×80 Ton
Main Pushing Cyl. Force:	200 Ton
Lifting Cyl. Force:	4×55 Ton
Hydraulic System Pressure:	25 MPa

### Hydraulic System (Piston Pump, 2 sets)

Type:	A10V160
Rated Displacement:	160 ml/r (/set)
Max Operating Pressure:	35 MPa

### Standard Configuration

NOK (JAPAN) Seal Packings for Cylinders;  
Oil Cooling & Filtering System; Tank Heater;  
Long Distance Data Transmission.

### Operation System

Siemens PLC & Remote Controller.

### General Description

Main Machine Size (L×W×H):	12292×1900×2250 mm
Press Chamber (L×W×H):	5850×2970×1010 mm
Bale Size (L×W×H):	1450×1010×620 mm
Production Rate (Steel):	baling 7-10 tons/hr, logging 12-15 tons/hr
Shipping Weight:	Approx. 33 tons
Loading (Standard Containers):	1×40'(HC)OT + 1×20'GP

### Hydraulic Oil Brand

Oil Tank Volume: 3500 ltr

ISO VG	China	U.S.		Britain	France
	GB11118.1	CALTEX CO.	MOBIL	SHELL	ELF CO.
HM 46	46 #	Rando HD46	D.T.E46	Tellus 46	Elfolna 46
HM 68	68 #	Rando HD68	D.T.E68	Tellus 68	Elfolna 68

Above information are indicative not engaging. Rights reserved for change if necessary.

# HBB-200DS

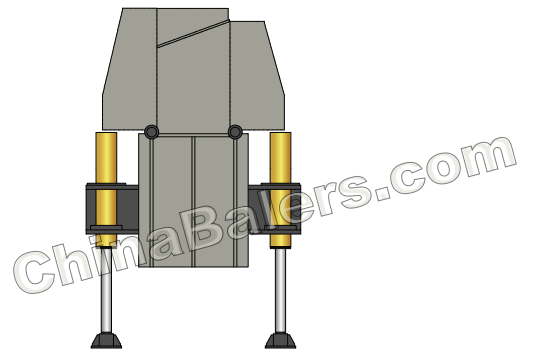
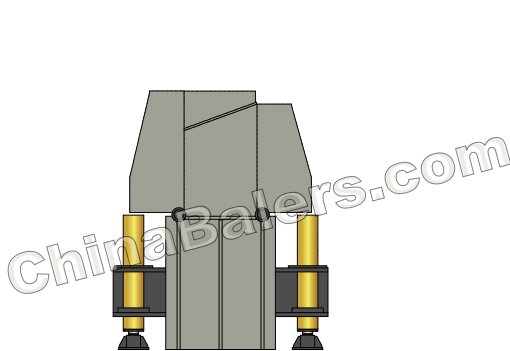
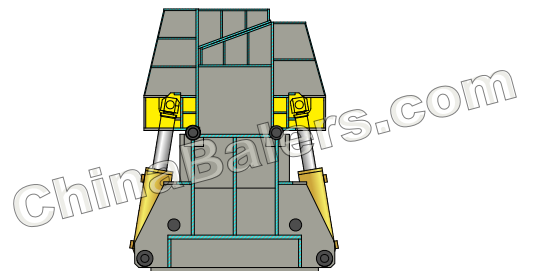
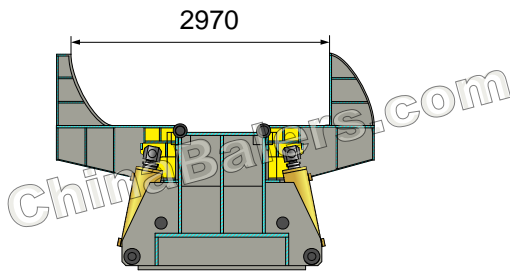
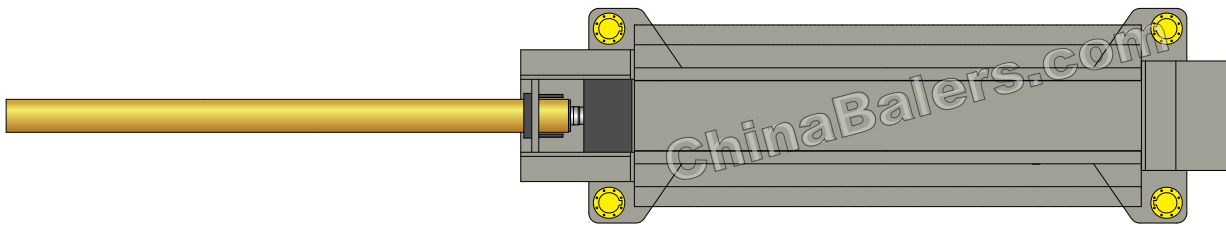
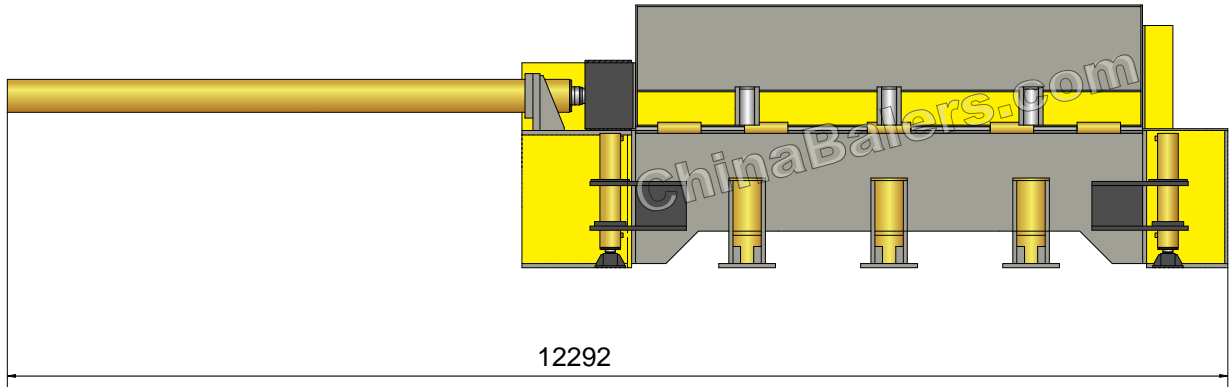
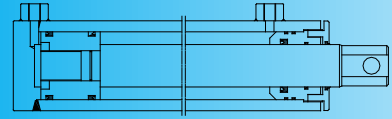

# HBB-200DS

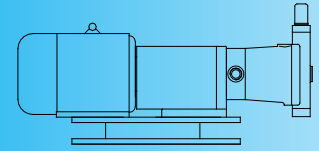

## Hydraulic Baler / Logger

Model: HBB-200DS

### Power System (Diesel Engine, 1 set)

Cummins Diesel:	6BTAA5.9-GM115
Rated Speed:	1500 rpm
Output:	120 kW

### System Parameters

Wing Cyl. Force:	3×80 Ton
Lid Cyl. Force:	3×80 Ton
Main Pushing Cyl. Force:	200 Ton
Lifting Cyl. Force:	4×55 Ton
Hydraulic System Pressure:	25 MPa

### Hydraulic System (Piston Pump, 2 sets)

Type:	A10V160
Rated Displacement:	160 ml/r (/set)
Max Operating Pressure:	35 MPa

### Standard Configuration

NOK (JAPAN) Seal Packings for Cylinders;  
Oil Cooling & Filtering System; Tank Heater;  
Long Distance Data Transmission.

### Operation System

Siemens PLC & Remote Controller.

### General Description

Main Machine Size (L×W×H):	12292×1900×2250 mm
Press Chamber (L×W×H):	5850×2970×1010 mm
Bale Size (L×W×H):	1450×1010×620 mm
Production Rate (Steel):	baling 7-10 tons/hr, logging 12-15 tons/hr
Shipping Weight:	Approx. 33 tons
Loading (Standard Containers):	1×40'(HC)OT + 1×20'GP

### Hydraulic Oil Brand

Oil Tank Volume: 3500 ltr

ISO VG	China	U.S.		Britain	France
	GB11118.1	CALTEX CO.	MOBIL	SHELL	ELF CO.
HM 46	46 #	Rando HD46	D.T.E46	Tellus 46	Elfolna 46
HM 68	68 #	Rando HD68	D.T.E68	Tellus 68	Elfolna 68

Above information are indicative not engaging. Rights reserved for change if necessary.



**Soochow Baling Machinery Ltd.  
Jiangsu Huahong Technology Stock Co., Ltd.**

**Factory:** Zhouzhuang, Jiangyin, Jiangsu

**Office:** Rm 1202, SIPCTD Bldg, No. 381 Suzhou Avenue East,  
Suzhou Industrial Park, Suzhou, Jiangsu 215028 China

**Tel:** +86 512 6255 1141 **Fax:** +86 512 6255 1142

**Email:** info@chinabalers.com; chinabalers@foxmail.com

**Website:** www.chinabalers.com; www.chinabalers.net